

PERMIT

SUBSURFACE ON-SITE SEWAGE TREATMENT SYSTEM

Environmental Health Program, Courthouse Room 308
256-2770

Date: 4/13/06

Building Permit #: 05-258
YCCHD Permit #: ~~13484~~ 13484

Site Location: 25 SUNLIGHT CIR

Legal Description: EMERALD EAGLE ESTATES SUB Lot 2 Block 3 Tract

Installer: CLEAR CREEK CONST.

Installed for: MCM CONTRACTING

Type of Dwelling: SFR Constructed for: 3 bedrooms / _____ gal/day.

Minimum Drainfield Size Requirements: 220 square feet/bedroom.

Total minimum amount of drainfield to be installed: 660 square feet; or 220 lineal feet. x 3' WIDE

Percolation Rate _____ minutes/inch Groundwater Depth _____ feet.

Water Supply: Well _____ Cistern _____ Public LOCKWOOD Other _____

Distance to Septic Tank N/A Distance to Drainfield N/A

Layout Details:

Tank Size: * 1000 _____ 1500 _____ 2000 gallons; other DOSE BANK COMBO

Material: Concrete * _____ Other _____ Tank to Foundation: 13'

Effluent Filter: Yes/No Yes

Trench Dimensions:

Gravel above pipe: 4" Depth to perf. pipe: 24"

Gravel below pipe: 8" Depth to bottom trench: 24"

Trench width: 36" Trench Nearest to Property Line: 10' WEST

System Type: STANDARD ~~UNANSWERED~~

Total Area Installed: 37' x 6' = 222' x 3' = 666 sq ft

PICS PRESSURE DISED 6'

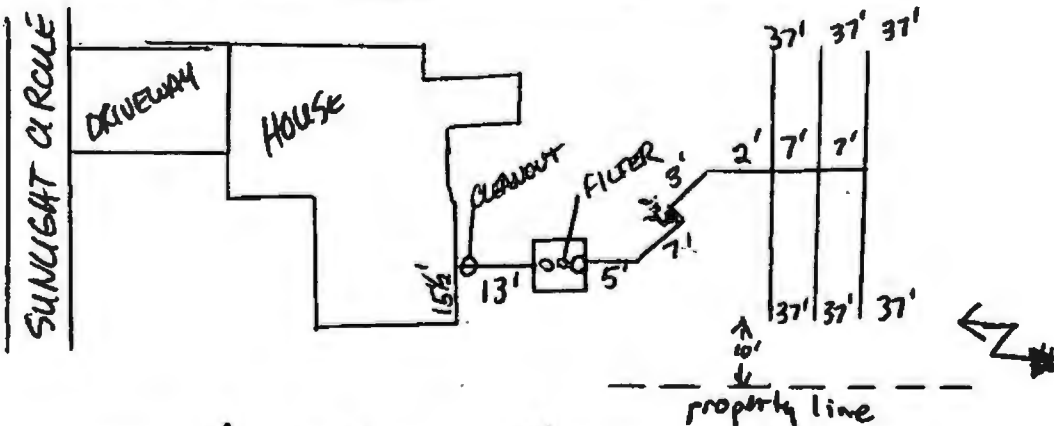

Approved: * _____ Denied: _____ Reason: _____

Installer: [Signature] Sanitarian: Russell Boyce, R.S.

Note: Inspection denotes compliance to plans submitted and to Yellowstone City-County Board of Health Rules and Regulations. It does not guarantee performance or longevity of system. (septic-permit - 06/01)