

PERMIT

SUBSURFACE ON-SITE SEWAGE TREATMENT SYSTEM

Environmental Health Program, Courthouse Room 308
256-2770

Date: 09-06-01 Building Permit #: Repair

YCCHD Permit #: 11737

Site Location: 1734 Groshelle

Legal Description: Groshelle Heights Lot _____ Block _____ Tract _____

Installer: Baker Const.

Installed for: Tom Wilson

Type of Dwelling: SFR Constructed for: _____ bedrooms / _____ gal/day.

Minimum Drainfield Size Requirements: Repair square feet/bedroom.

Total minimum amount of drainfield to be installed: _____ square feet; or _____ lineal feet.

Percolation Rate _____ minutes/inch Groundwater Depth _____ feet.

Water Supply: Well Cistern _____ Public _____ Other _____

Distance to Septic Tank _____ Distance to Drainfield _____

Layout Details:

Tank Size: 1000 _____ 1500 _____ 2000 gallons; other _____

Material: Concrete Other _____ Tank to Foundation: 10' +

Effluent Filter: Yes No

Trench Dimensions:

Gravel above pipe: N/A Depth to perf. pipe: _____

Gravel below pipe: N/A Depth to bottom trench: 26"

Trench width: 24 in Trench Nearest to Property Line: 10' +

System Type: Standard Chamber

Total Area Installed: 294 Sq. Ft.

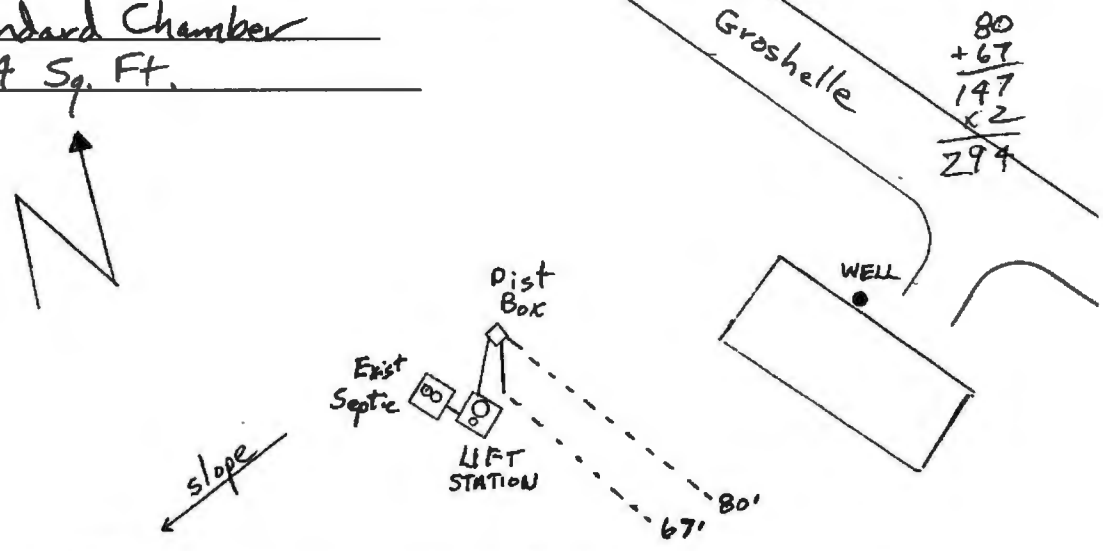

Approved: Denied: _____ Reason: _____

Installer: Baker Const. Inc. / T. Baker Sanitarian: Scott Vandell, R.S.