



622 COVE CRESCENT

5 BED | 4 BATH | 2763 SQ.FT.

www.PinnacleHomesGroup.com

778-404-7668

eXp Realty



THE HOME

5 BEDS / 4 BATHS

Experience the pinnacle of Oceanview luxury at 622 Cove Crescent, a newly completed masterpiece in the prestigious Deep Cove area of North Saanich. This custom-built, 3-story home spans 2,763 sq. ft. and features 5 bedrooms, 4 bathrooms, and a flawless modern exterior. Inside, luxury awaits with hardwood floors, quartz countertops, custom cabinetry, and top-tier appliances in the chef-inspired kitchen. The open-concept living area is awash with natural light, showcasing a cozy fireplace and custom-built elegance. The tranquil primary suite boasts a deluxe 4-piece stunning ensuite and Ocean Views to wake up too. The home overall is finished with meticulous attention to detail, offering panoramic ocean views throughout many rooms and from the outdoor balconies and deck. Located just steps from the ocean, Deep Cove Marina, and Chalet Beach, this home offers unparalleled luxury living and convenience, encapsulating the essence of the sought-after Deep Cove lifestyle. Explore this exceptional offering and make 622 Cove Crescent the setting for your next chapter of luxury living.



THE FEATURES

Upon entry, you will love the flooring in the foyer leading to a spacious open floor plan. Complete with a functional main level floorplan. In your sights, you will see the modern designer kitchen including Fisher & Paykel appliances and quartz countertops. The en-suite was built for his or her dream bathroom including a, a beautiful walk in shower with gorgeous tiling, double sinks and illuminated mirrors. Other features include a office space, dining area, main powder room, a 2 car garage, a gas fireplace, a fenced backyard with ocean views, and a large backyard.



THE PRIMARY BEDROOM

The extravagant primary bedroom is perfect to come home to with a walk-out deck, beautiful walk-in closet and its luxurious 4-piece ensuite, sleek walk-in shower, gorgeous tiling, illuminated mirrors, and double sinks.



THE KITCHEN

The kitchen is clearly the heart of this lovely home and is perfect for entertaining family, friends, and loved ones throughout the year. With premium Fisher & Paykel appliances, quartz countertops, plentiful cupboard space and a spacious pantry. Additional features include, a gas range, French Door Refrigerator, and an expansive island that leads into the living or dining room.





THE GUEST SUITE

622 Cove Crescent provides a separate Legal 1 bed- room and 1 bathroom suite with it's own kitchen, laundry, and living area. An additional 851 sq ft, this versatile space is perfect for family, friends, teens, or tenants.

THE EXTERIOR

Built in 2024, 622 Cove Crescent is a paragon of modern architecture, showcasing meticulous design precision. The facade presents a symmetrical marriage of neutral grey hues and inviting wooden textures, punctuated by streamlined contours and an abundant integration of glass that seamlessly merges the interior with the exterior environment. Thoughtful illumination highlights its crisp geometric angles, contributing to the structure's distinguished character. A commodious garage complements the home's stylish functionality. The entryway is a sophisticated interplay of stone, wood, and glass, forming an exquisite portal to this modern sanctuary.



THE FLOOR PLANS:

2763 Finished SqFt
 Main Floor - 1000 Sqft
 Upper Floor - 912 Sqft
 Lower Floor - 851 Sqft

9' Ceiling Height - Main
 9' Ceiling Height - Upper
 9' Ceiling Height - Lower

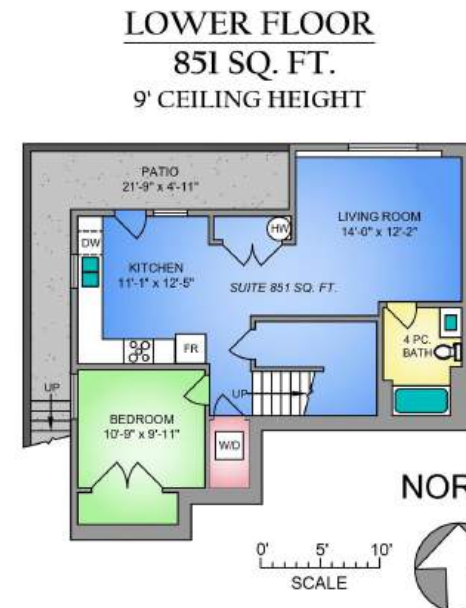

622 Cove Crescent AT A GLANCE...

BUILT: 2024

BEDROOMS: 5

BATHROOMS: 4

FINISHED AREA: 2763 sq ft.

LOT SIZE: .138 Acres Lot

WATER: City

WASTE: City

INCLUDED ITEMS:

- Fisher & Paykel French Door Refrigerator
- Fisher & Paykel Double Dishwasher
- Elica Palermo Range Hood
- Fisher & Paykel 36" Gas Range
- Samsung Laundry Package
- Whirlpool In-suite Laundry appliances (Suite)
- Whirlpool Refrigerator (Suite)
- Whirlpool Dishwasher (Suite)
- Electric Car Charger Rough In

INTERIOR HIGHLIGHTS:

- Stunning Spacious Kitchen
- Premium appliances
- Quartz countertops
- Open concept living
- Separate Legal 851 sqft 1 Bedroom Suite

HEATING/COOLING:

- Heat pump (auxiliary heat/cooling)
- Propane Fireplace

EXTERIOR HIGHLIGHTS:

- Large Patio
- Wrap around Balcony
- Fenced private backyard
- Concrete walkout patio
- Concrete driveway
- 2 Car Garage
- Ample Parking
- Easy care landscaping
- Fully irrigated yard
- Separate Hydro Meter Suite



THE LOCATION

Deep Cove - North Saanich

This amazing property is located in the peaceful and private town of North Saanich. Enjoy multiple beach access points at your fingertips. Nearby you will find the Deep Cove Market , Deep Cove Chalet, Winery, & Horth Hill Park. This property is minutes to great amenities, schools, and Shopping Centers. Short drive to main highways as well as a 35-minute drive to downtown Victoria. This is a sought-after location within walking distance of the beach and local parks and only a short drive to downtown Sidney, the Anacortes Ferry, Victoria International Airport and Swartz Bay Ferry Terminal. The satisfaction and affection for the quality of life and the environment is perhaps the most notable feature of this area today.

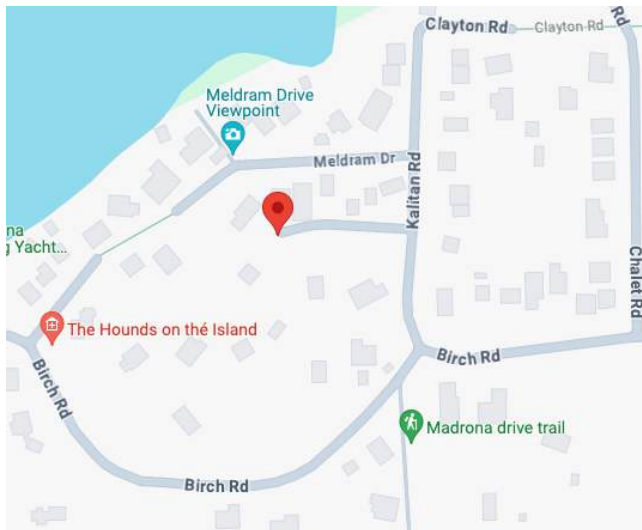

SCHOOLS IN THE AREA

University/College

- *University of Victoria*
- *Camosun College*

Middle School

- *North Saanich Middle School*
- *Dunsmuir Middle School*

High Schools

- *Parkland Secondary*
- *Stelly's Secondary*

Elementary Schools

- *Deep Cove Elementary*
- *Sidney Elementary*

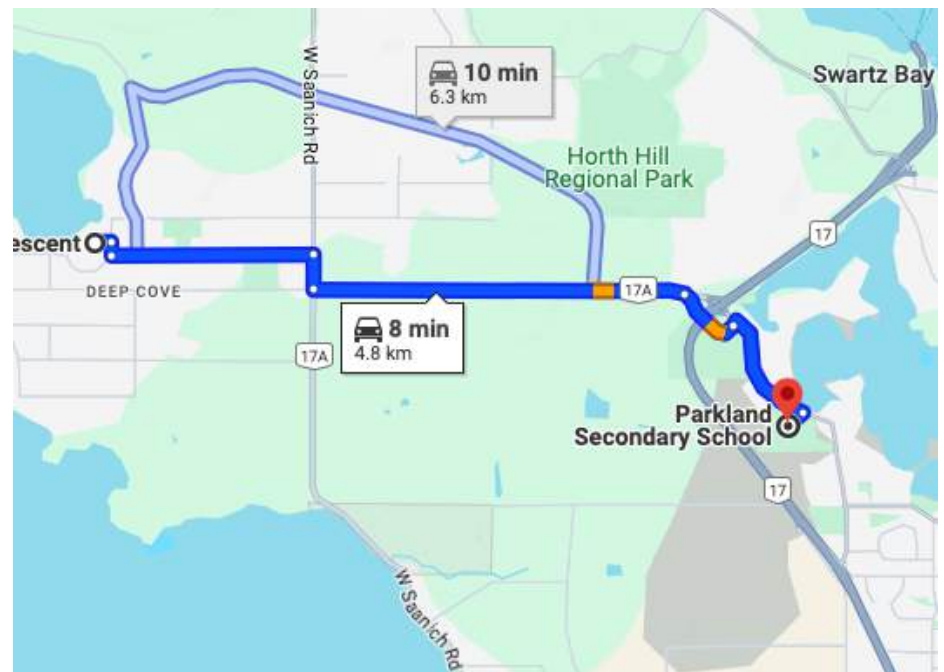
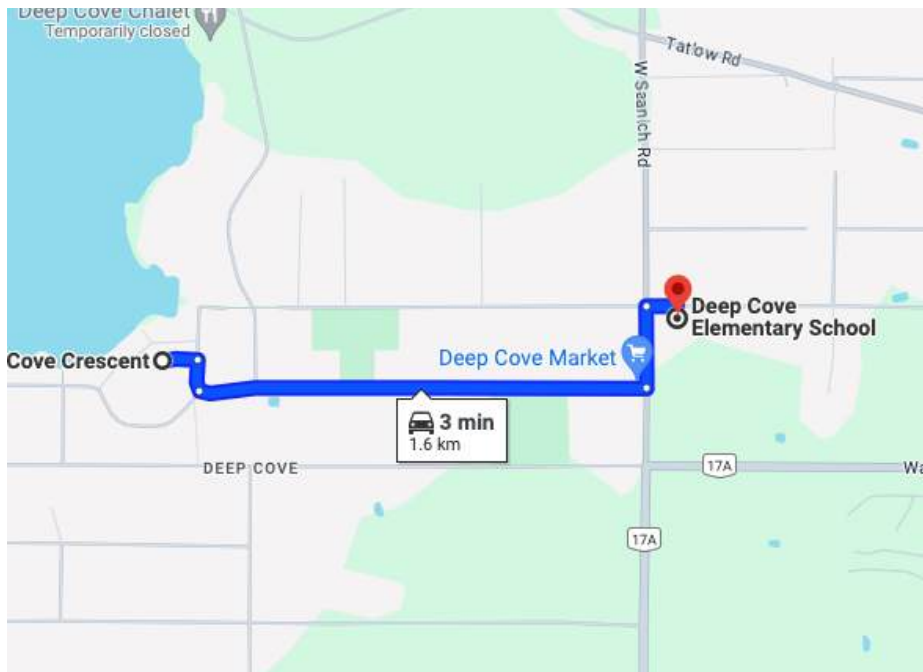







Thomas Kala* & Courtney Kala*

*Personal Real Estate Corporation

Pinnacle Homes Group

eXp Realty

778-404-7668

Thomas@pinnaclehomesgroup.com

Courtney@pinnaclehomesgroup.com

Not intended to solicit properties currently listed for sale or individuals currently under contract with a Brokerage. This information is from sources which we deem reliable, but must be verified