

CONTACT: NICOLE BEND

PHONE: 403-465-4328

EMAIL: ADMIN@CALGARYLISTINGS.COM

WEBSITE: WWW.CALGARYLISTINGS.COM

MEASUREMENT SUMMARY AND ROOM DIMENSIONS

**ADDRESS: 208, 45 ASPENMOUNT HT SW**

CALGARY, ALBERTA

PROPERTY TYPE: APARTMENT

MEASURED ON: OCTOBER 9, 2020

BEDROOMS: 3

BATHROOMS: 2.5

## MAIN INFO

Main Floor Above Grade Area (RMS)	896.2sq.ft.	83.3sq.m.	8'6" Ceiling
Upper Level Above Grade Area (RMS)	515.7sq.ft.	47.9sq.m.	8'6" Ceiling
<b>Total RMS</b>	<b>1411.9sq.ft.</b>	<b>131.2sq.m.</b>	
Finished Below Grade	n/a		
Unfinished Below Grade	n/a		
<b>Total Below Grade</b>	<b>n/a</b>		
Exterior Wall Thickness	n/a		

## MAIN FLOOR

Kitchen	10'7"x9'5"
Living Room	17'1"x12'1"
Dining Room	10'6"x9'10"
Master Bedroom	16'9"x10'4"
5pc Ensuite Bath	8'9"x8'6"
Foyer	6'11"x5'2"
Laundry/Storage Room	8'7"x5'7"
2pc Bathroom	6'3"x2'11"

## AUXILIARY AREA

Balcony	10'0"x8'0"
---------	------------

## SECOND FLOOR

Bedroom	11'1"x10'6"
Walk-in Closet	6'6"x4'3"
Bedroom	11'9"x11'2"
3pc Bathroom	9'5"x6'6"
Storage Room	4'8"x2'3"

403-585-3839



CALGARY PHOTOS  
[WWW.CALGARYPHOTOS.CA](http://WWW.CALGARYPHOTOS.CA)

[INFO@CALGARYPHOTOS.CA](mailto:INFO@CALGARYPHOTOS.CA)

All Measurements Certified, Guaranteed and Insured through Calgary Photos.  
Areas are calculated using RECA RMS measurement standards and are covered under E&O through Calgary Photos.  
Calgary Photos retains copyright and ownership of all measurements, payment by the client permits use for listing purposes.  
This report is non-transferable and may not be re-sold.

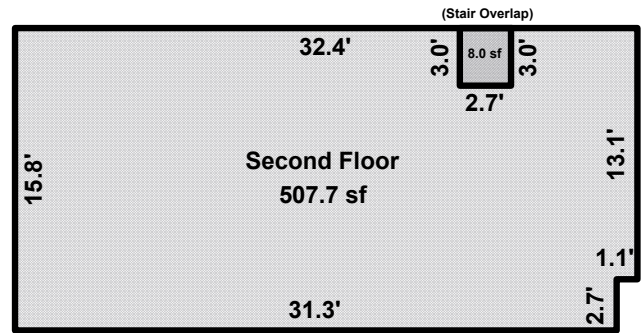
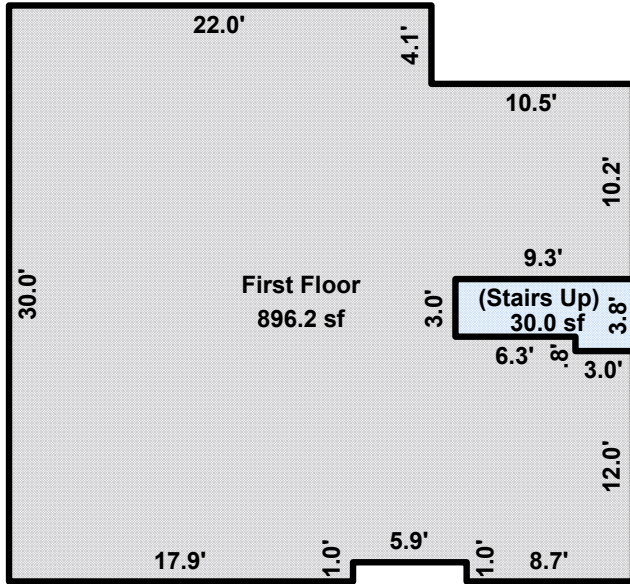

Measured by Cory Moore / Calgary Photos

Sketch by Apex Sketch

Code	Description	Factor	Net Size	Perimeter	Net Totals
GLA1	First Floor	1.0	896.2	145.5	896.2
GLA2	Second Floor	1.0	507.7	96.3	
	Second Floor	1.0	8.0	11.3	515.7
UND	Open	1.0	30.0	26.0	30.0

Net LIVABLE

(rounded)

1,412