

**YELLOWSTONE CITY-COUNTY HEALTH DEPARTMENT
SUBSURFACE SEWAGE TREATMENT SYSTEM**

PERMIT

DATE OF PERMIT 5-2-86

BUILDING PERMIT Ⓐ B 12-86 #
CLASS ① 2
Y.C. PERMIT NO. 7195

SITE LOCATION 833 Ollie St.

LEGAL DESCRIPTION C/S 1794 Lot Blk Tract 1-A

Installer Ray Smith
Installed for Ray Smith

Type of Dwelling S.F.R. Constructed/Designed for 3 bdrms

Water Supply: Well Cistern Public
Distance to septic tank 50' Distance to drainfield 105'

MINIMUM DRAINFIELD REQUIREMENTS: 220 sq ft / bdrm. Sq. ft/bdrm
Percolation Rate min/in. Depth of groundwater 76' ft.

LAYOUT DETAILS:

Tank Size: 1,000; 1500; 2000 gal. Material: Concrete Other
Tank to Foundation: 6' ft. Trench to property line ft.

TRENCH DIMENSIONS:

Gravel above pipe 2-3" in. Gravel below pipe 8-10" in.
Depth to Perf. pipe 24-26" in. Depth to bottom trench 34-36" in.
Trench width 24" System type trenches

Total Area Installed: 662 sq ft.

DIAGRAM

CALCULATIONS

*soil profile
is heavy clay*

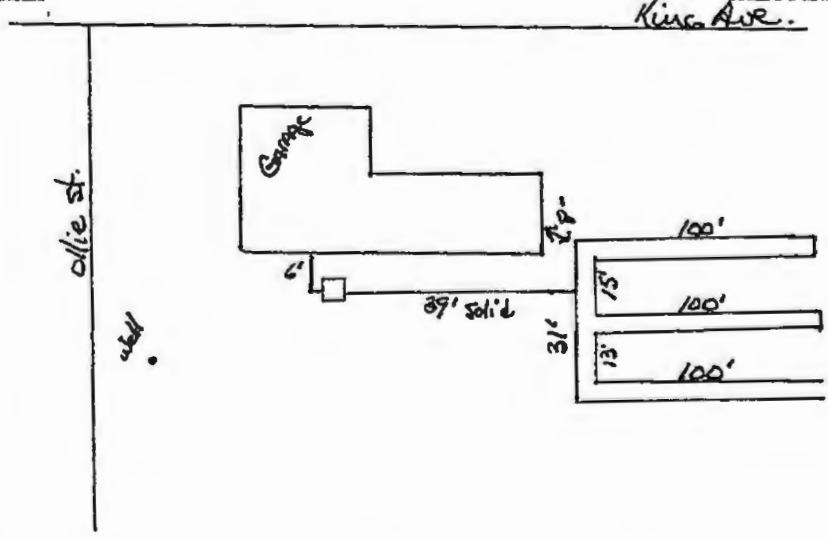

100
100
100
31
331 lin. ft.
2
662 sq. ft.

APPROVED: DENIAL REASON:

INSTALLER Ray Smith SANITARIAN T. Klander, R.S.

NOTE: Inspection denotes compliance to plans submitted and to Yellowstone County Rules and Regulations. It does not guarantee performance or longevity of system.

PSB